





NORTH SHORE
CHANNEL PARK

OAKTON ST

ST. LOUIS AVE

MCCORMICK BLVD

Existing Mini Golf

Existing
Driving Range

Existing
Detention

Existing
Maintenance
Facility

Existing
Nicor Facility

Existing
Detention

Existing
ComEd Facility

P
+/- 168
spaces

- Synthetic turf
- Full size soccer field
- Existing access
- Cricket pitch
- **Ballfield 1**
Fence & backstop
70', 80', 90' baselines
- Parking lot expansion
- Pavilion
- Playground
- **Ballfield 3**
60', 70' baselines
- **Ballfield 2**
Fence & backstop
70', 80', 90' baselines

SITE DATA

- Cricket pitch
- 2 full-size baseball fields
- 1 little league baseball field
- 2 full-size soccer fields
- +/- 4.5 acres of synthetic turf
- +/- 352 parking spaces

MWRD
WASTEWATER
TREATMENT PLANT





Automated batting cages
 New clubhouse
 Golf pavilion
 Golf learning area
 Playground, splash pad
 and fitness stations

Improve at-grade pedestrian crossing
 Synthetic turf with stormwater detention in stone base
 Cricket pitch
 Full size soccer field, typical
Ballfield 1
 Fence & backstop
 70', 80', 90' baselines
 Practice soccer fields
 Pavilion
 Batting practice cages
 Walking path
Ballfield 2
 Fence & backstop
 70', 80', 90' baselines
Ballfield 3
 60'/70' baselines
 Parking lot expansion
 Service access
 Sidewalk

SITE DATA
 Cricket pitch
 2 full-size baseball fields
 3 full-size soccer fields
 3 practice/youth fields
 +/- 6 acres of synthetic turf
 +/- 307 parking spaces

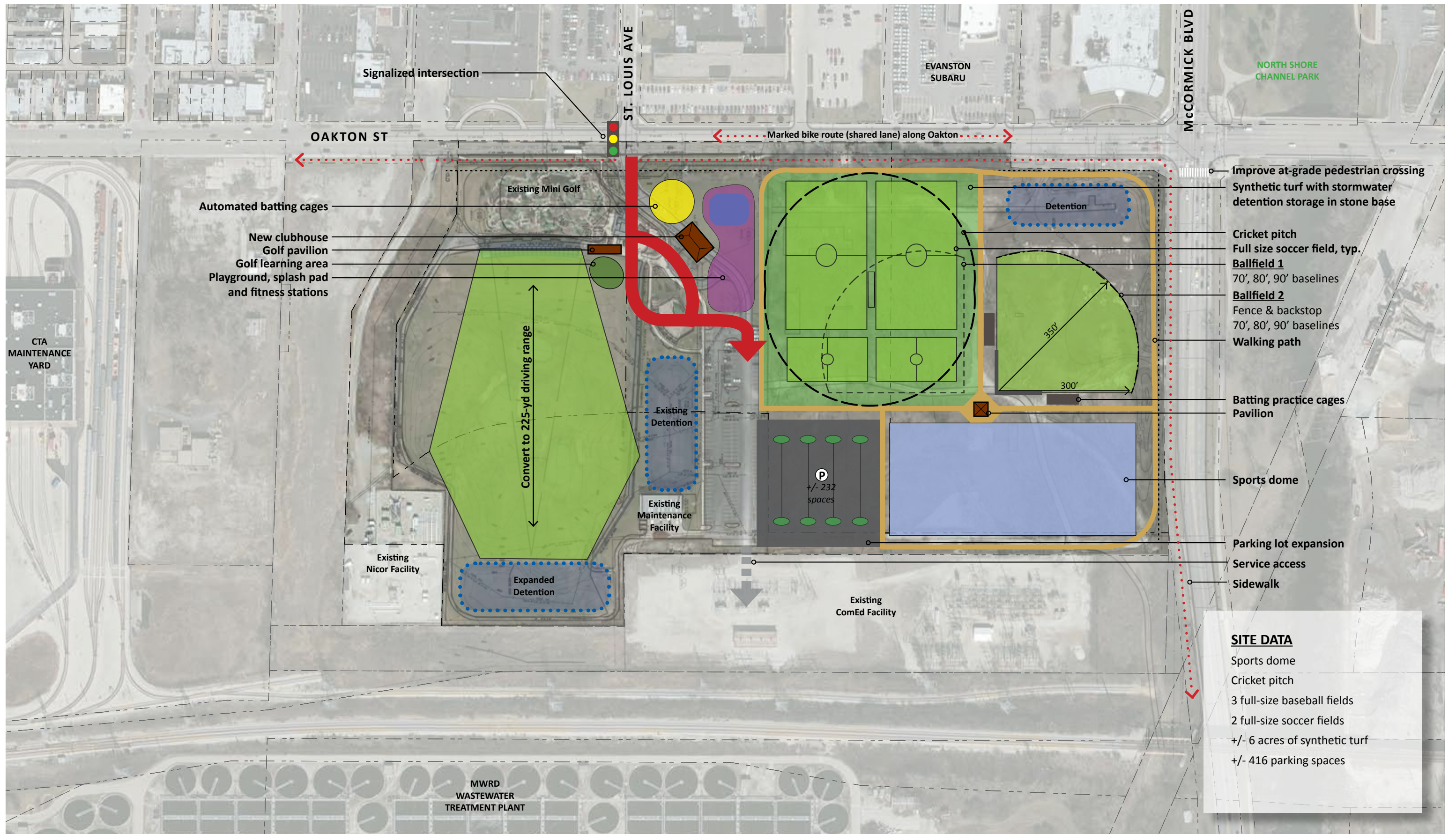

Automated batting cages
 New clubhouse
 Golf pavilion
 Golf learning area
 Playground, splash pad
 and fitness stations

Convert to 225-yd driving range

Improve at-grade pedestrian crossing
 Synthetic turf with stormwater
 detention storage in stone base
 Cricket pitch
 Full size soccer field, typ.
Ballfield 1
 70', 80', 90' baselines
Ballfield 2
 Fence & backstop
 70', 80', 90' baselines
 Walking path
 Batting practice cages
 Pavilion
 Sports dome
 Parking lot expansion
 Service access
 Sidewalk

SITE DATA
 Sports dome
 Cricket pitch
 3 full-size baseball fields
 2 full-size soccer fields
 +/- 6 acres of synthetic turf
 +/- 416 parking spaces

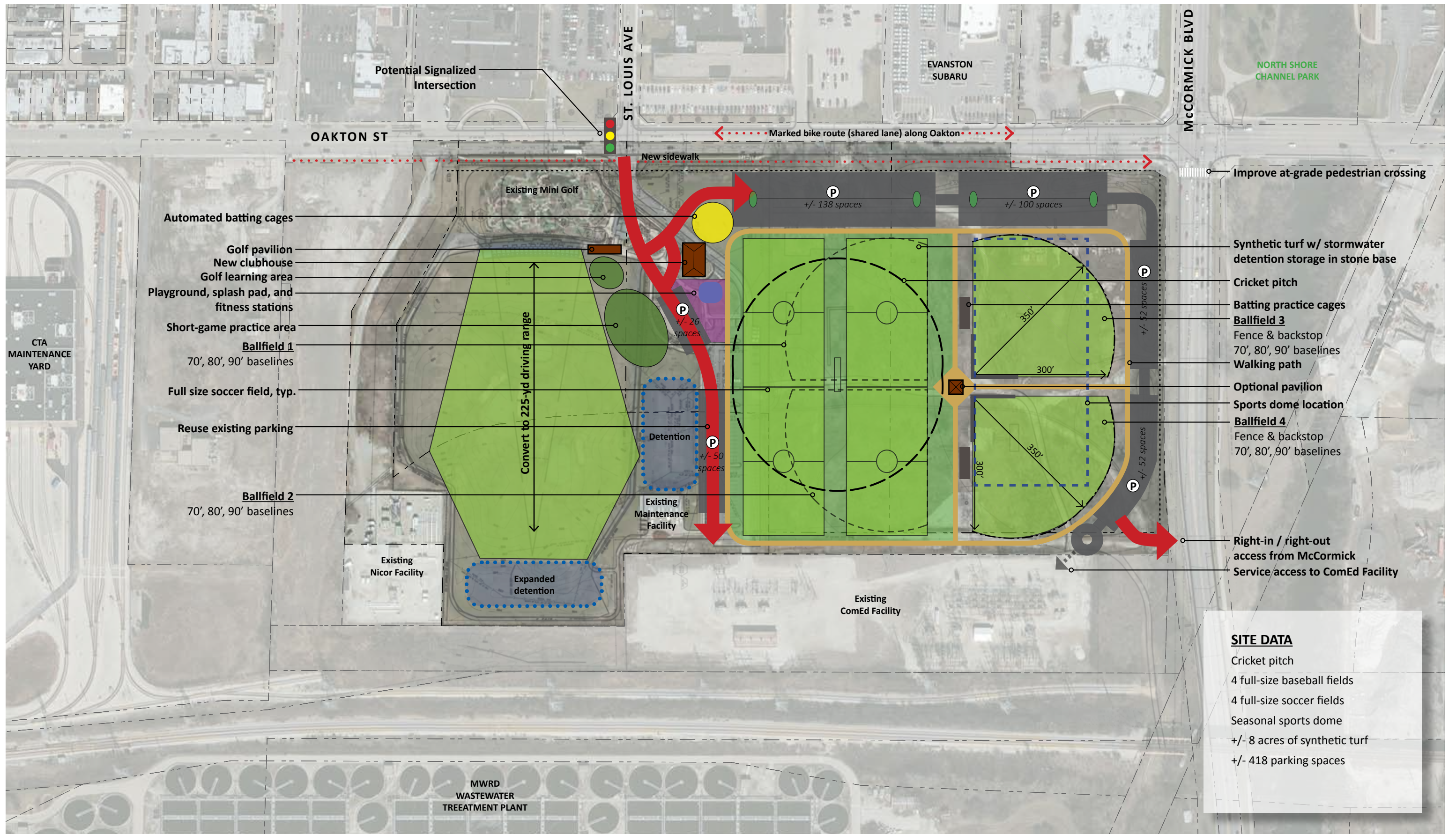

- Automated batting cages
- Golf pavilion
- New clubhouse
- Golf learning area
- Playground, splash pad, and fitness stations
- Short-game practice area
- Ballfield 1**
70', 80', 90' baselines
- Full size soccer field, typ.
- Reuse existing parking
- Ballfield 2**
70', 80', 90' baselines

- Improve at-grade pedestrian crossing
- Synthetic turf w/ stormwater detention storage in stone base
- Cricket pitch
- Batting practice cages
- Ballfield 3**
Fence & backstop
70', 80', 90' baselines
Walking path
- Optional pavilion
- Sports dome location
- Ballfield 4**
Fence & backstop
70', 80', 90' baselines
- Right-in / right-out access from McCormick
- Service access to ComEd Facility

SITE DATA

- Cricket pitch
- 4 full-size baseball fields
- 4 full-size soccer fields
- Seasonal sports dome
- +/- 8 acres of synthetic turf
- +/- 418 parking spaces



SITE DATA

- Cricket pitch
- 1 premier ball field with grandstand
- 2 full-size baseball fields
- 1 little league baseball field
- 4 full-size soccer fields
- +/- 8 acres of synthetic turf
- +/- 342 parking spaces

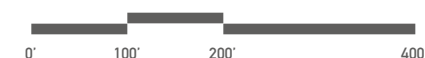

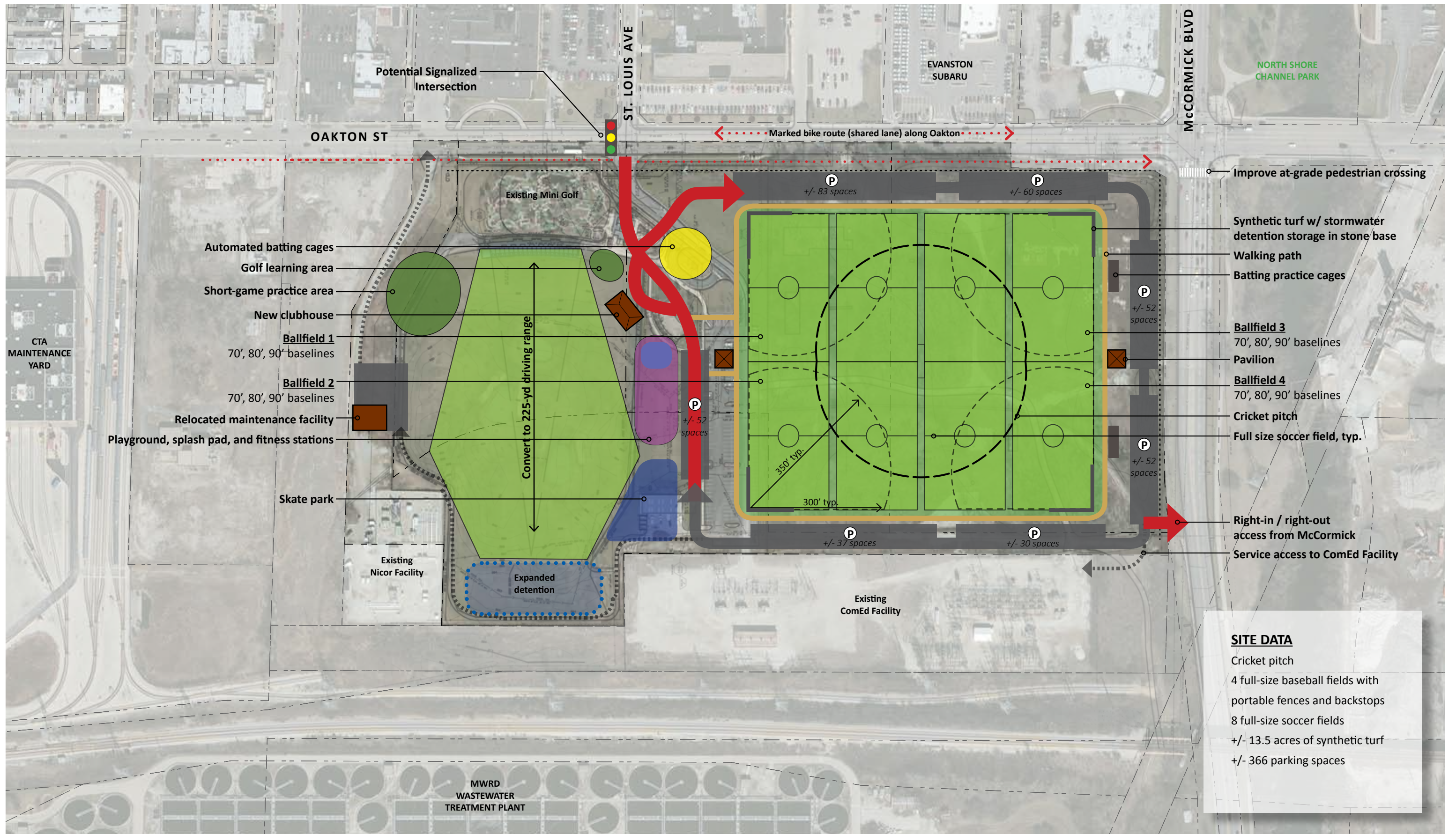

SITE DATA

- Cricket pitch
- 4 full-size baseball fields with portable fences and backstops
- 8 full-size soccer fields
- +/- 13.5 acres of synthetic turf
- +/- 366 parking spaces